



origin

DOORS AND WINDOWS

OS-29, OS-44 & OS-77 Installation Guide

Installation Guide

Components box

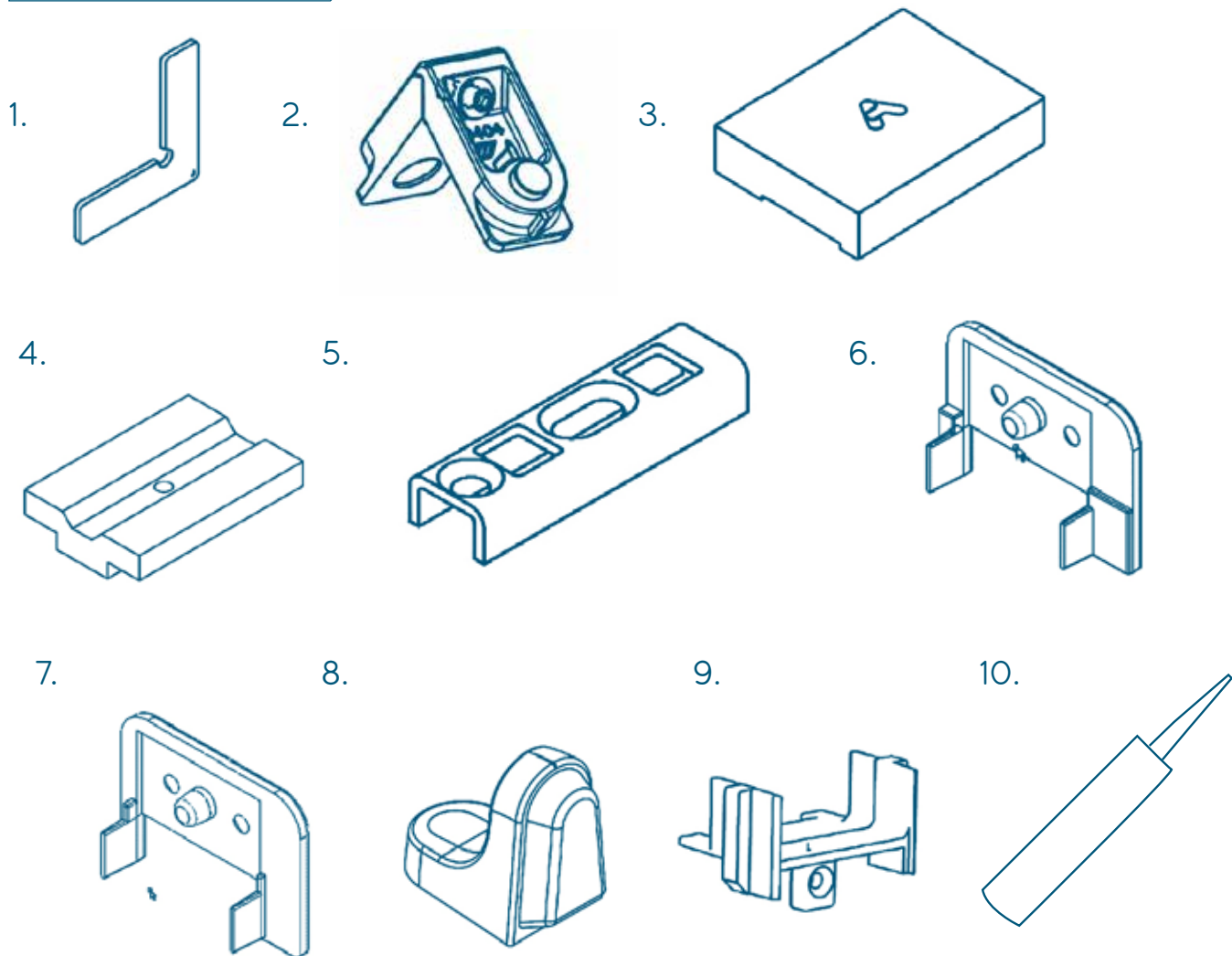

Also included: Handles, Appropriate Glazing Gasket, Cylinder/ keys, Fixed sash fixings (4.8 x 80mm)

Contents

- | | | |
|------------------------|-----------------------------|---|
| ▶ 1. Alignment Chevron | ▶ 5. Shoot Bolt Keep | ▶ 8. Door Stop |
| ▶ 2. Frame Cleat | ▶ 6. End Cap (OS-44/ OS-77) | ▶ 9. Slave Lockstile End Cap
For 4 & 6 door Slider |
| ▶ 3. Fixed Sash Space | ▶ 7. End Cap (OS-29) | ▶ 10. Interlock Silicon
(OS-29/ OS-44) |
| ▶ 4. Anti-Lift Block | ▶ 8. Door Stop | |

Preparation

1. Check all components have been delivered (see components box items on page 48)
2. Check opening sizes are correct to ordered size
3. Check the substrate is plumb, level and flat/ replace any damaged or missing DPC under the threshold/ cill
4. The cill/ track must be supported across its depth to prevent twisting when the weight of the door is applied (Metal Packers are available for bottom track)

Measure and check the aperture width and height

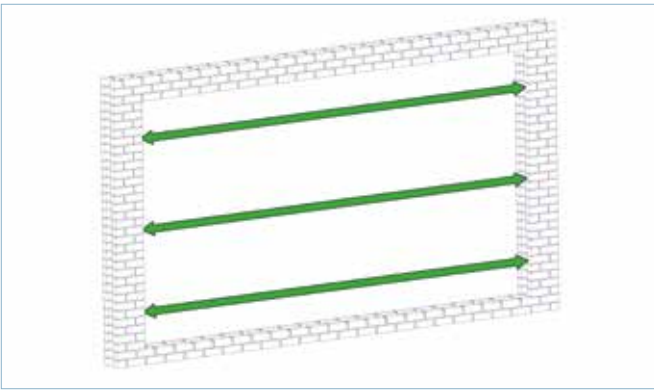

FIG 1

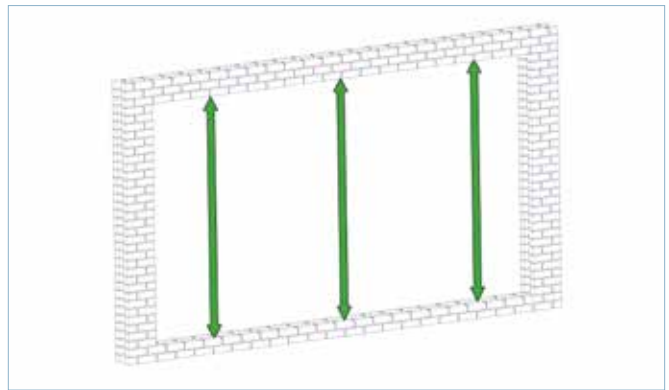

FIG 2

Level the threshold in both directions, packing every 500mm apart for the length of the opening.

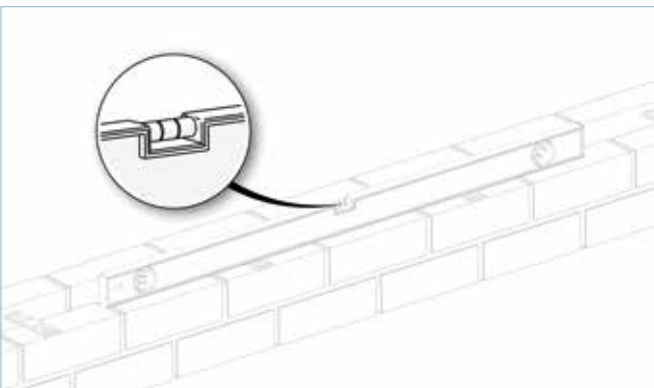

FIG 3

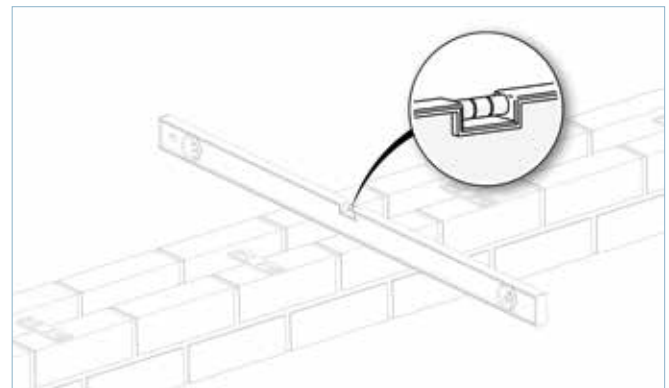

FIG 4

Frame Install

1. Lay out the frame components (as labelled) in your work area
2. Insert the alignment chevrons. Location – directly beneath brush gasket position (FIG 6)
3. Apply sealant to the ends of the bottom track and attach the jambs, completely filling the bottom chambers where the water sits and around the edges
4. Align corners using the chevrons and then tighten using the 4mm allen key, making sure the joint is fully together. Once the corners are fully attached, fill the cleat locating holes and screw holes with silicone (this is essential on the bottom track) (FIG 7 & 8)
5. Wipe off the excess sealant
6. Attach the head to the jambs using the same process as described in points 2-5 above

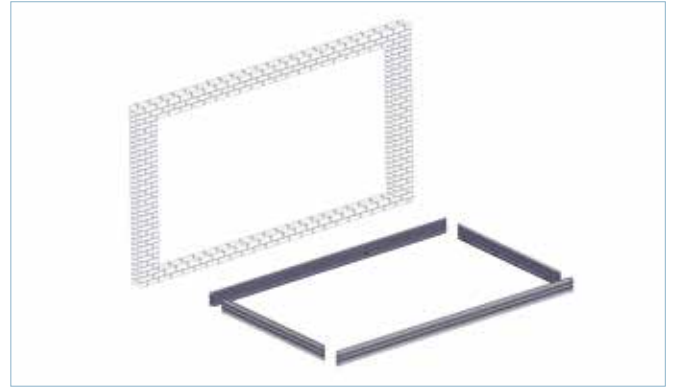

FIG 5

Lay frame profiles in front of aperture, being careful not to scratch the powder coat.

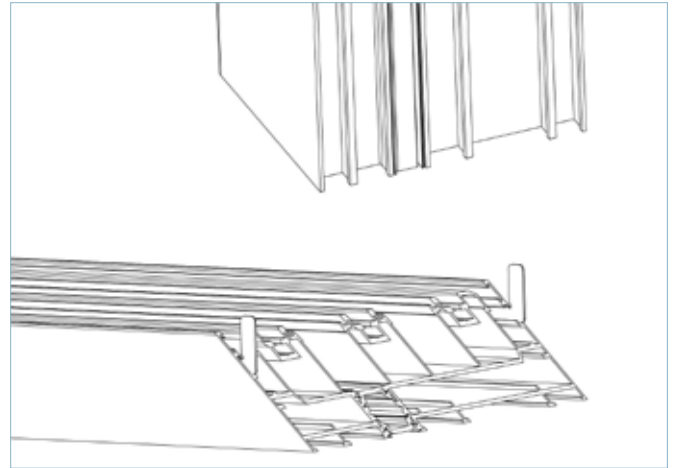

FIG 6

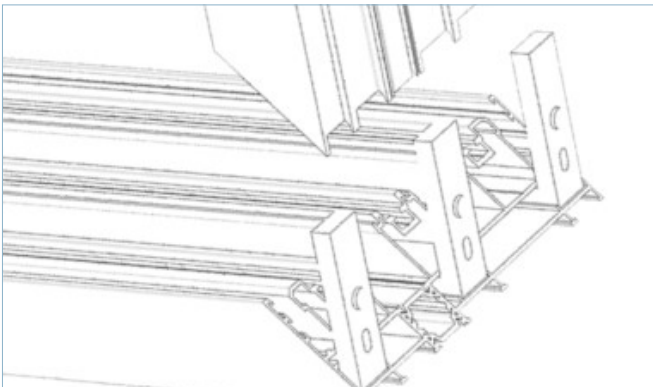

FIG 7

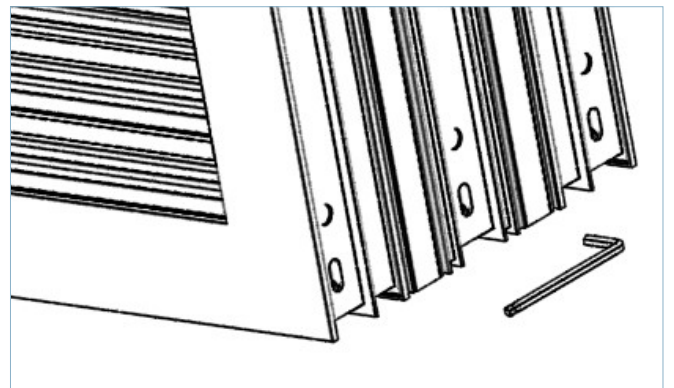

FIG 8

Frame Install

1. Ensure that the bottom track/ cill is set flat and level and is supported along the whole length, making sure that the packing points are no less than 500mm apart
2. If using a drip bar, ensure that when fitted, all pre-drilled holes are filled with silicone before being fixed into position with the screws supplied (FIG 9)

A consistent bead of silicone is required between the drip bar and the track to ensure a complete seal

3. Offer the frame into the opening. Pack down above the top 2 corners to hold the frame in place (FIG 10 & 11)
Check bottom track for level and make adjustments if necessary
4. Jambs must be plumb and straight – pack as necessary when fixing to avoid bowing or twisting (FIG 12 – 15)
5. Using suitable frame fixings, secure the bottom track and both jambs into position
NB: All fixings through the bottom track must be filled with an all-weather sealant before fixing
6. Check the frame is square and adjust if required

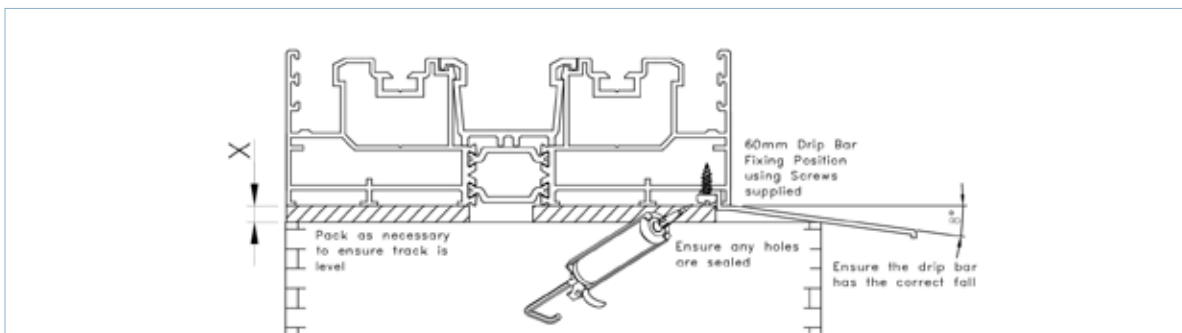

FIG 9



FIG 10

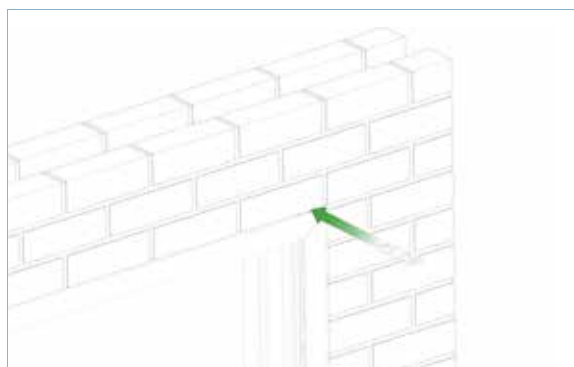

FIG 11 Insert packers above both jambs

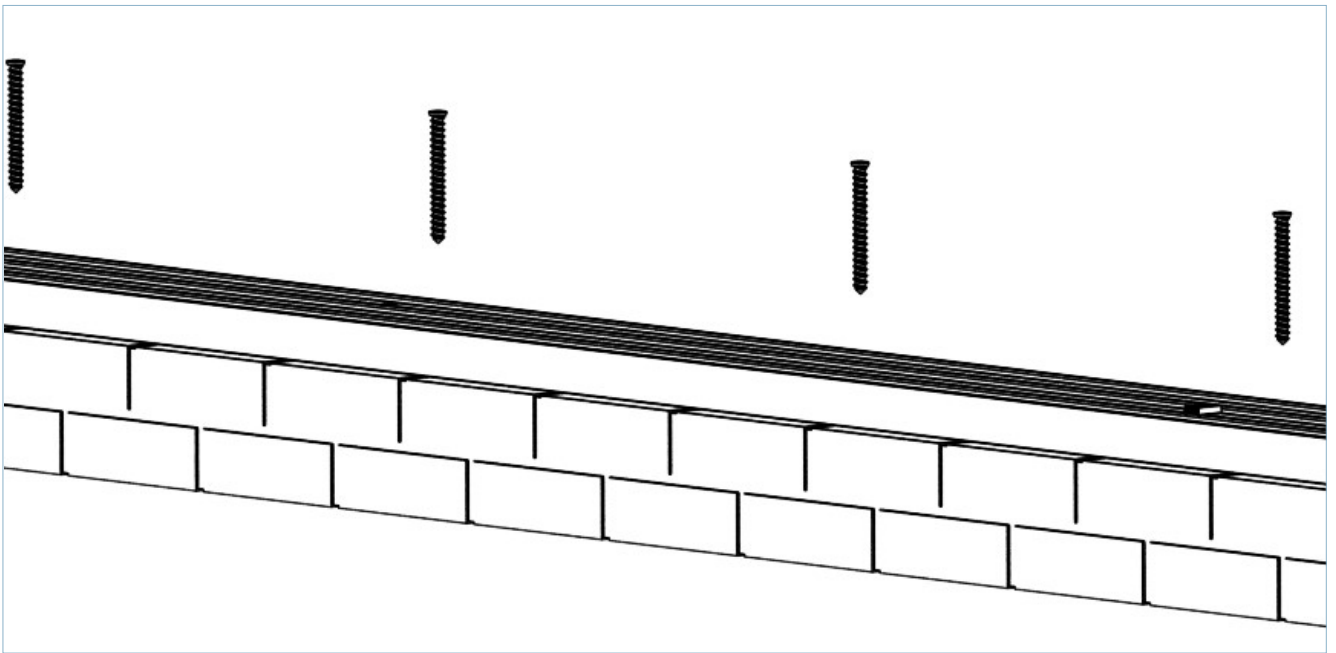

FIG 12

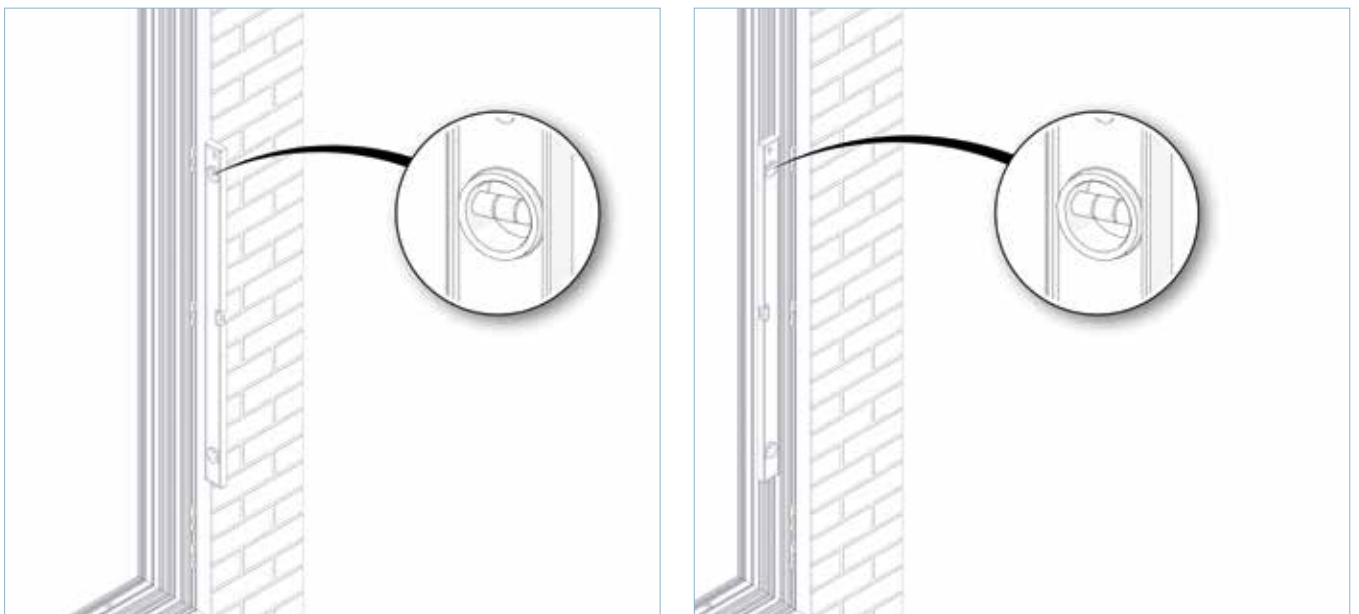

FIG 13

Level out jambs in both directions

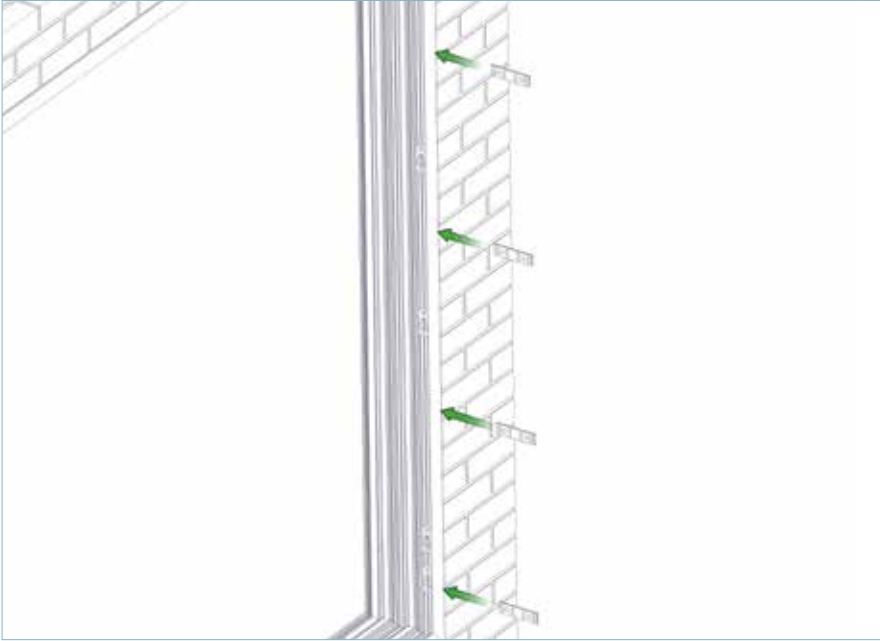

FIG 14

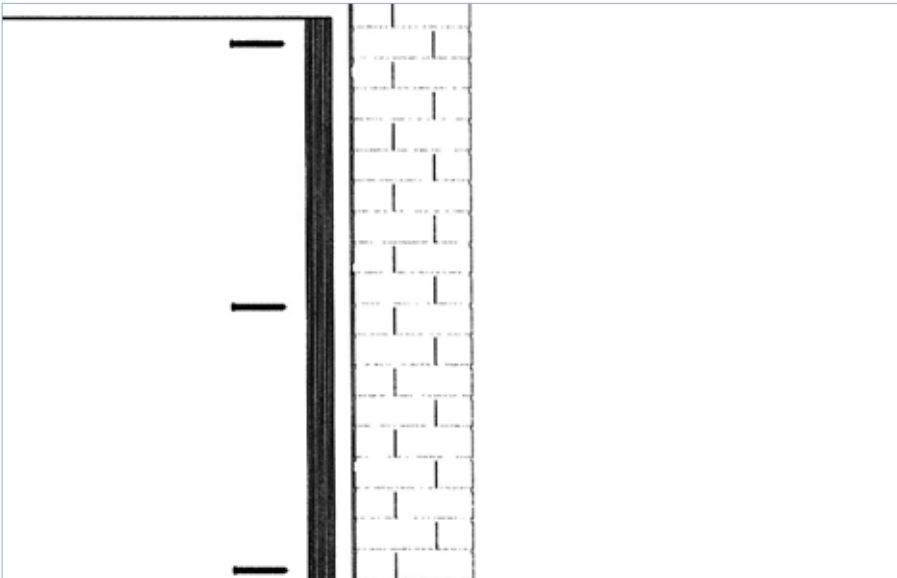

FIG 15

Sash Install

1. If having a fixed sash, ensure the supplied sash packers are installed prior to installing the sashes

Fixing blocks should be spaced evenly around the frame at approx 500mm apart and screwed into the frame where the sash will sit

2. Insert the sash into the top track as far as possible (FIG 16)
 - b. Swing the bottom in and lower, so that the wheels of the roller engage on to its runner (FIG 17)

3. Repeat for all sashes

NB: *It may be necessary to lift the top track slightly to allow the bottom of the sashes to cross the runner*

4. If applicable, locate the fixed sash into place and secure using the screws provided

The sash should be lifted into position where there are no fixing blocks, then slid/ lifted into place. Fix using 4.8 x 80m screws provided. Fix through the polyamide as close to the fixing blocks as possible. When doing this, check the level of the sash on the interlocker

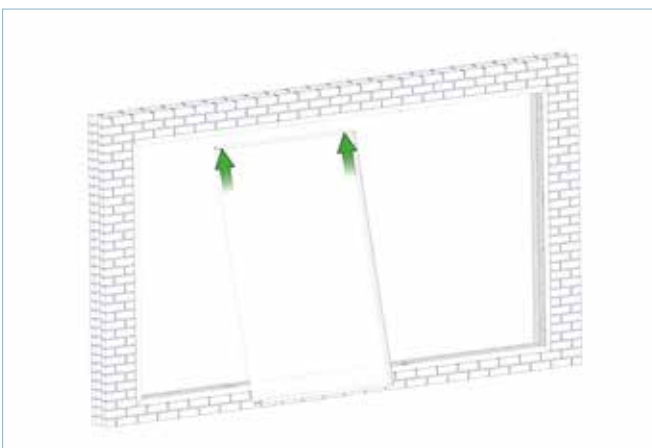

FIG 16

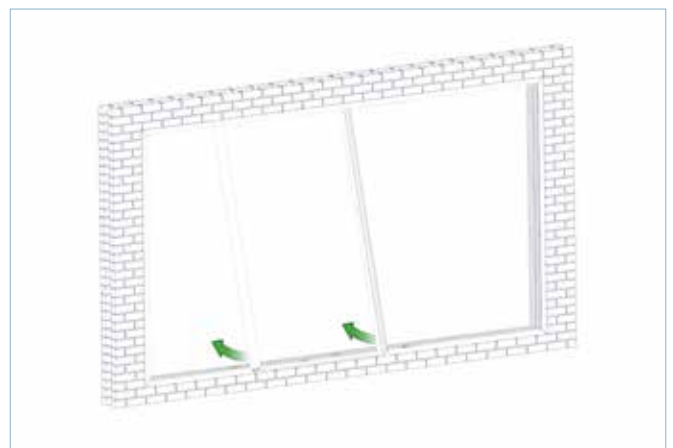

FIG 17

5. Ensure all sashes are running smoothly
6. Ensure that the sashes are level and run smoothly on the track.
Ensure that the sashes are plumb at the meeting stiles and check that the interlocks engage. Make sure that the locking sash locks correctly when in the closed position
7. The sash can be levelled by adjusting the roller using a Hex 5 or PH2 long screwdriver depending on roller carriage used. The roller adjustment can be located at the bottom side of the sash (interlock side) (FIG 18)
8. The top track can now be fully secured. Care should be taken to ensure it is not bowed or twisted and is level along the entire length (FIG 19)

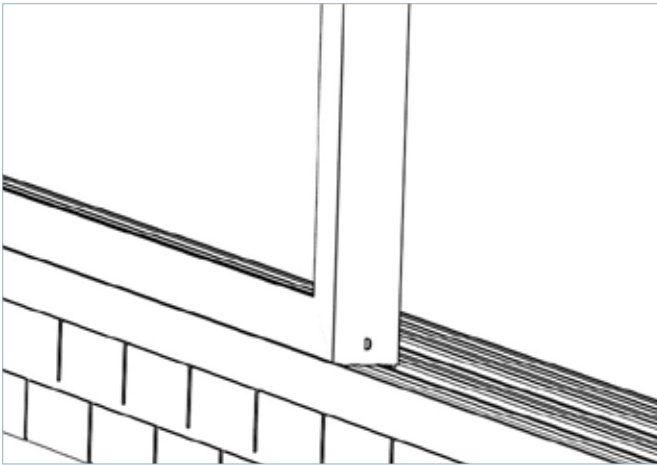

FIG 18

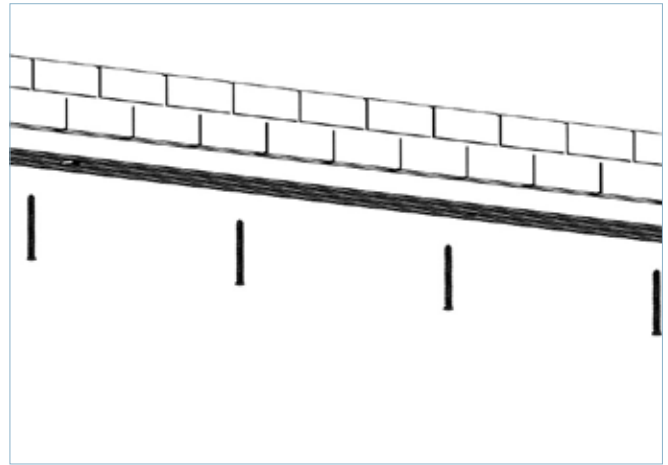

FIG 19

Glazing

1. Start with the outside sash and work inwards
2. 4mm glazing packers should be positioned directly above each roller
3. Secure a 4mm packer in the glazing chamber and install the glazing bead on the side of the sash behind the adjoining sash interlocker

Install the top and bottom beads first, then the sides. Glaze from the outside sash to inside. Glaze, bond (if required) and wedge before moving to the inner sashes

If installing an OS-44 or OS-29, the glass should be bonded to the interlock using the supplied bonding agent. This should be a continuous bead, the full length of the interlock

4. Lift glass into position. Pack appropriately, making sure the sash remains square
For the OS-44 or OS-29, make sure not to pack too tightly, forcing against the interlock, to avoid any twisting, as this can result in the interlocks clashing
5. Insert a short length of wedge gasket into the previously installed bead to make sure it remains in position
6. Install the remaining beads and insert the wedge gasket along all four sides
7. Repeat the steps above until all glass units have been installed
8. For the OS-44 or OS-29, ensure that the interlock remains square and is not twisted after glazing to avoid interlocks clashing

Use a straight edge on the interlock to ensure that this remains straight after installing the wedge gasket

Installation Guide

1. Insert cover trims into jamb and track (if applicable)
2. Insert end caps into prepped holes on the interlock (inside and out) and install the supplied screws. The small brush strip fits to the back of the cap before fixing (FIG 20)
3. For 4 & 6 pane doors, end caps are fitted top and bottom of the slave door to close the gap where the sliding doors meet (FIG 21)
4. Insert the shoot bolt keeps into the top and bottom track and insert the provided screw into the slotted hole. Check the sash locks into place smoothly and the side to side movement is kept to a minimum. Once adjustment is complete, install the remaining screws (FIG 22)
5. With the doors closed, mark the track (non-permanent mark) 150mm in from each side of each sash. Slide open the door and fix the anti-lift blocks into position, in line with the previously made marks
6. Open the locking sash to the fully open position (being careful to allow space for the operators fingers between the handle and interlock). Locate the door stops on the bottom and top of the sash and fix into place using the supplied screws (FIG 23)

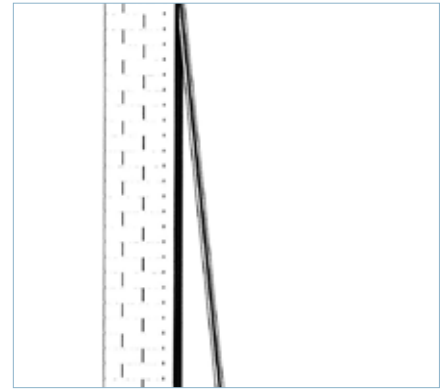

FIG 20

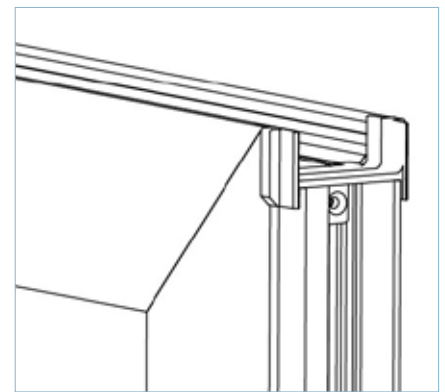

FIG 21

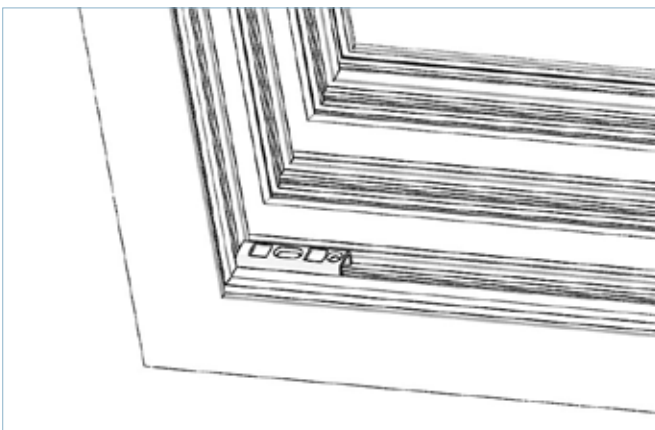

FIG 22

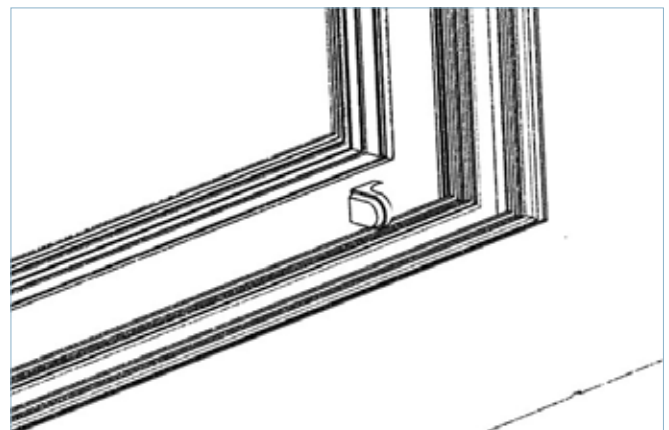

FIG 23

Components List

Component	Code
Alignment Chevron	C00135
Frame Cleat	X209
Fixed Sash Spacer	C00514
Anti-Lift Block	X238
Shoot Bolt Keep	L191
End Cap (OS-44/ OS-77)	X229
End Cap (OS-29)	C01561
Door Stop	X212
Slave Lockstile End Cap For 4 & 6 door Sliders	X115
Interlock Silicon (OS-29/ OS-44)	C00546
Offset bar handle	H045
300mm All-in-one handle	H113

Contact

Accounts

t 08448 802 371 or 01494 416 895 **e** Finance@origin-global.com

Marketing

t 08448 802 374 or 01494 416 897 **e** Marketing@origin-global.com

Sales Operations

t 0808 168 5816 or 01494 686 868 **e** OrdersNorth@origin-global.com

e OrdersSouth@origin-global.com

Fleet and Logistics

t 08448 802 378 or 01494 416 898 **e** Logistics@origin-global.com

origin
DOORS AND WINDOWS

Origin Global HQ, Stuart House, Castle Estate,
Coronation Road, High Wycombe
Buckinghamshire, HP12 3TA

t 0808 168 5816
e enquiry@origin-global.com
w www.origin-global.com

